

PM1546

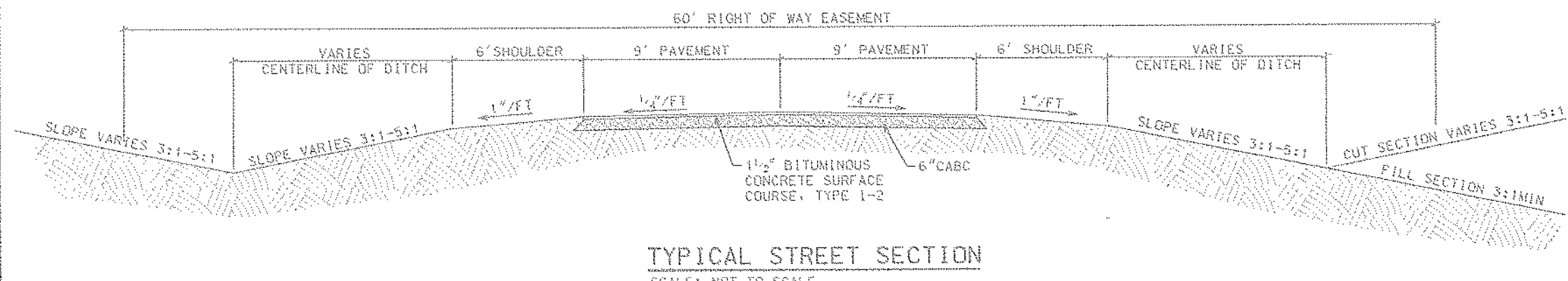

TYPICAL STREET SECTION
SCALE: NOT TO SCALE

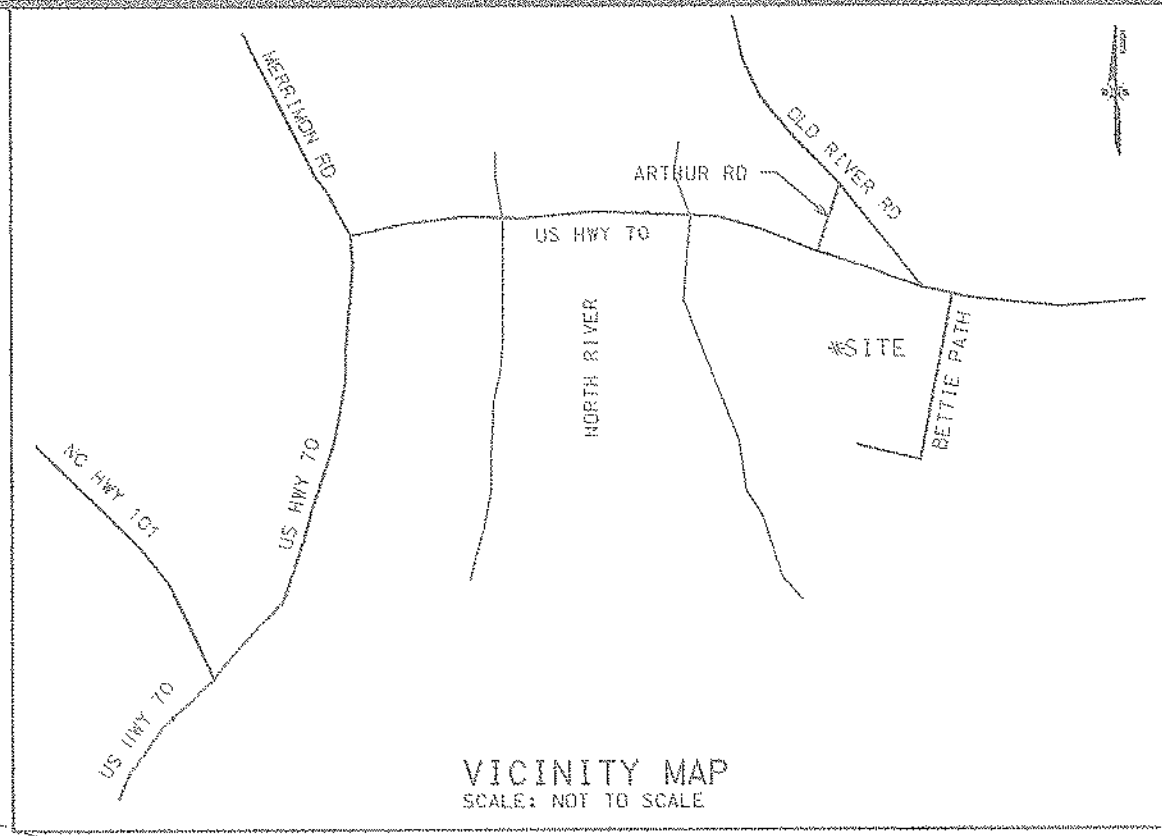

VICINITY MAP
SCALE: NOT TO SCALE

N 17° 08' 32" W
MB 29 PG 964-967

CURVE DATA

LENGTH	103.89
RADIUS	150.00
CHORD	101.83
CH. BEARING	S38°01'48"W
LENGTH	57.05
RADIUS	200.00
CHORD	56.85
CH. BEARING	S66°02'36"W
LENGTH	40.65
RADIUS	300.00
CHORD	40.62
CH. BEARING	S19°40'00"E
LENGTH	40.48
RADIUS	300.00
CHORD	40.45
CH. BEARING	N19°59'02"W
LENGTH	66.75
RADIUS	300.00
CHORD	66.61
CH. BEARING	N17°08'32"W



PROPERTY LINE TAKEN FROM MAP PREPARED BY JAMES I. PHILLIPS LAND SURVEYING, P.A., ENTITLED NORTH RIVER ESTATES, PHASE 1, LOTS 2-8 AND 10, DATED MAY 2001. (REFERENCE MB29 PG964-967)

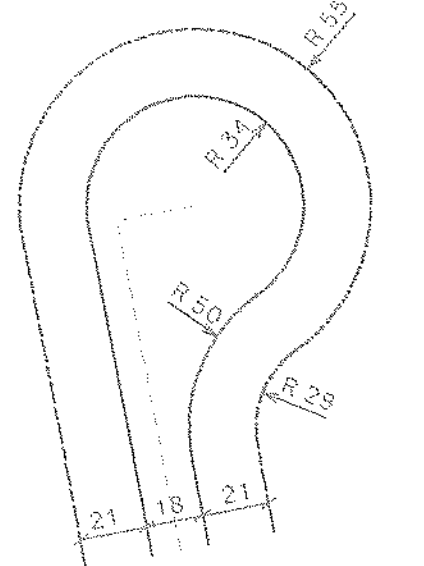

CUL-DE-SAC DETAIL
SCALE: 1" = 60'

LEGEND

- AC ACRES
- CH CHORD
- DB DEER BARK
- EOP EXISTING EDGE OF PAVEMENT
- EX EXISTING
- FE FINISHED ELEVATION
- INV INVERT
- LF LINEAR FOOT
- MLB MINIMUM BUILDING LINE
- MOB MINIMUM BUILDING LINE
- PC PAVED
- RADIUS
- R/W RIGHT OF WAY
- RCP REINFORCED CONCRETE PIPE
- SF SQUARE FOOT
- TYP TYPICAL
- X- SILY FENCE
- COASTAL WETLAND
- 404 WETLAND

- NOTES:**
- BOUNDARY, LOCATION AND TOPOGRAPHIC INFORMATION PROVIDED BY ATLANTIC COAST PROFESSIONAL SURVEYING, P.A., ENTITLED NORTH RIVER ESTATES, DATED 2/23/05.
 - THE DEVELOPER SHALL NOT DISTURB AND LAND WITHIN THE 75' AEC UNLESS STATE PERMITS ARE APPLIED FOR AND ISSUED BY THE DIVISION OF COASTAL MANAGEMENT. INDIVIDUAL LOT OWNERS MUST APPLY FOR CMA MINOR WHEN CONSTRUCTION ENCRUSCHES INTO THE 75' AEC.
 - ALL FLOOD ZONE LINES ARE APPROXIMATE AND TAKEN FROM FIRM PANEL 7328J, MAP NO. 3720732800J, DATED JULY 16, 2003.
 - LOT PURCHASERS FOR 2 & 3 SHALL SUBMIT DRIVEWAY CROSSING PERMITS TO APPROPRIATE STATE AND FEDERAL AGENCIES.

REVISIONS:

NO.	BY	DATE	DESCRIPTION

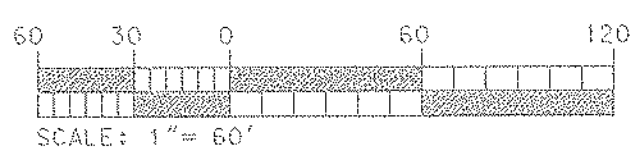

SHEET # 1 OF 2
PROJECT #: PM1546
DESIGN FILE #: 1546/pm1546.dgn

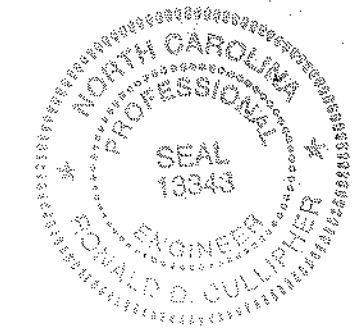

SITE PLAN

NORTH RIVER ESTATES

BETTIE COMMUNITY, STRAITS TOWNSHIP, CARTERET COUNTY

CLIENT: WILMINGTON COMMERCIAL PROPERTIES, LLC
C/O ERNEST DEANS HACKNEY, JR.
ADDRESS: PO BOX 3442
WILMINGTON, NC 28406
PHONE: (910) 392-3379

DESIGNED: RDC
DRAWN: CYT
CHECKED: RDC
APPROVED: RDC

STROUD ENGINEERING, P.A.
151A HIGHWAY 24
MOREHEAD CITY, N.C. 28557
(252) 247-7479
Ronald D. Cullipher 4/15/05
RONALD D. CULLIPHER, P.E.

DATE: 4/15/05
SCALE: 1" = 60'