

INSTALLATION GUIDE SWING PATIO DOORS



@ag_millworks

Tag us in your
installation photos
and videos to be
featured on our
page!



We suggest prefinishing or prepainting doors before installation.

This unit will not operate or lock properly if the frame is not

PERFECTLY PLUMB, LEVEL AND SQUARE.

**ENSURE THE JAMB IS INSTALLED 100% PLUMB, LEVEL AND SQUARE USING A LASER
LEVEL DEVICE, 6' OR 8' LEVEL AND OR A STORY POLE.**

**If a factory service call is requested and the cause of the issue is found to be
a unit installed out of square and/or plumb, the service call will be billed to the
customer.**

IMPORTANT:

This unit has been engineered to work with the weatherstripping installed on the unit. If weatherstripping must be removed for painting or finishing, please make note of where it goes before removing it. It is the installer's and or painters responsibility to replace all weatherstripping in exactly the same locations as installed by factory. Failure to do so may cause the unit to leak water and air.

**IMPORTANT: A SILL PAN AND PROPER WATERPROOFING (BY OTHERS) ARE
REQUIRED FOR PROPER INSTALLATION OF THIS UNIT FIG 2.**

**These are not step-by-step instructions. Manufacturer assumes no liability for
omissions/errors and/or installation errors. Please call the factory if there are any
questions 1-800-559-9995**

Instructions are written as viewed from EXTERIOR side of unit

Thank you for ordering Swing Patio Doors from AG Millworks. This unit was completely built-up with all hardware installed in our factory. The unit was fully tested and components were adjusted and then the doors were removed, marked and boxed, and the frame may have been disassembled and boxed. Please contact the factory before making any hardware adjustments.

Step 1:

K.D. Unit (Knocked Down) Assembly

If the frame was delivered fully assembled then skip to *Step 2*. If the frame was not delivered assembled, assemble and screw together the four sections of the frame: (1) Head Jamb, (2) Jamb legs, (1) Sill using generous amounts of the provided high-quality silicone caulking **FIG. 1** on next page.

Step 2:

Place the frame into the opening and be sure it is **completely plumb, level and square**. Don't forget to apply a minimum of two beads of silicone caulking and/or flashing material to waterproof the unit. **Our flashing fins are non-structural and not intended to be used as an anchoring device or nailing fin, see FIG 5.**

The installer has various options for securing the sill depending on the job site, **e.g. a generous amount of high quality sealant such as OSI Quad Max**. However, be sure all products are compatible with one another. Ultimately, the installer needs to determine the best method to prevent the sill from lifting off the subfloor. Secure the frame into the opening **completely plumb, level and square**. See **FIG 3** for basic sill pan information.

Check again to be sure the jamb is **plumb, level and square** before continuing. **ANCHORING THE SILL IS MANDATORY.**

FIG 1: Frame Assembly

Apply generous amounts of high-quality silicone caulking to the top of the Leg Jamb and bottom of Head Jamb. Use the 2-1/2" screws provided to fasten Head Jamb to Leg Jamb through the top of the Head Jamb.



Apply generous amounts of high-quality silicone caulking to the side of the Leg Jamb and sill. Use the 2-1/2" screws provided to fasten Sill to Leg Jamb through the side of the Leg Jamb.



FIG 2: Aluminum Sill

Out-swing Sill:

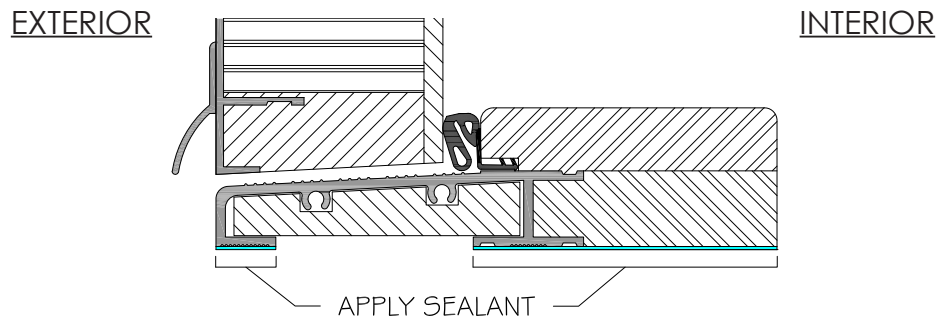

In-swing Sill:

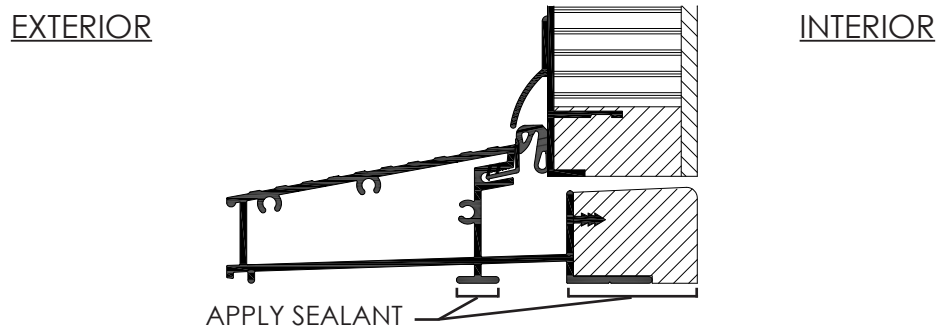
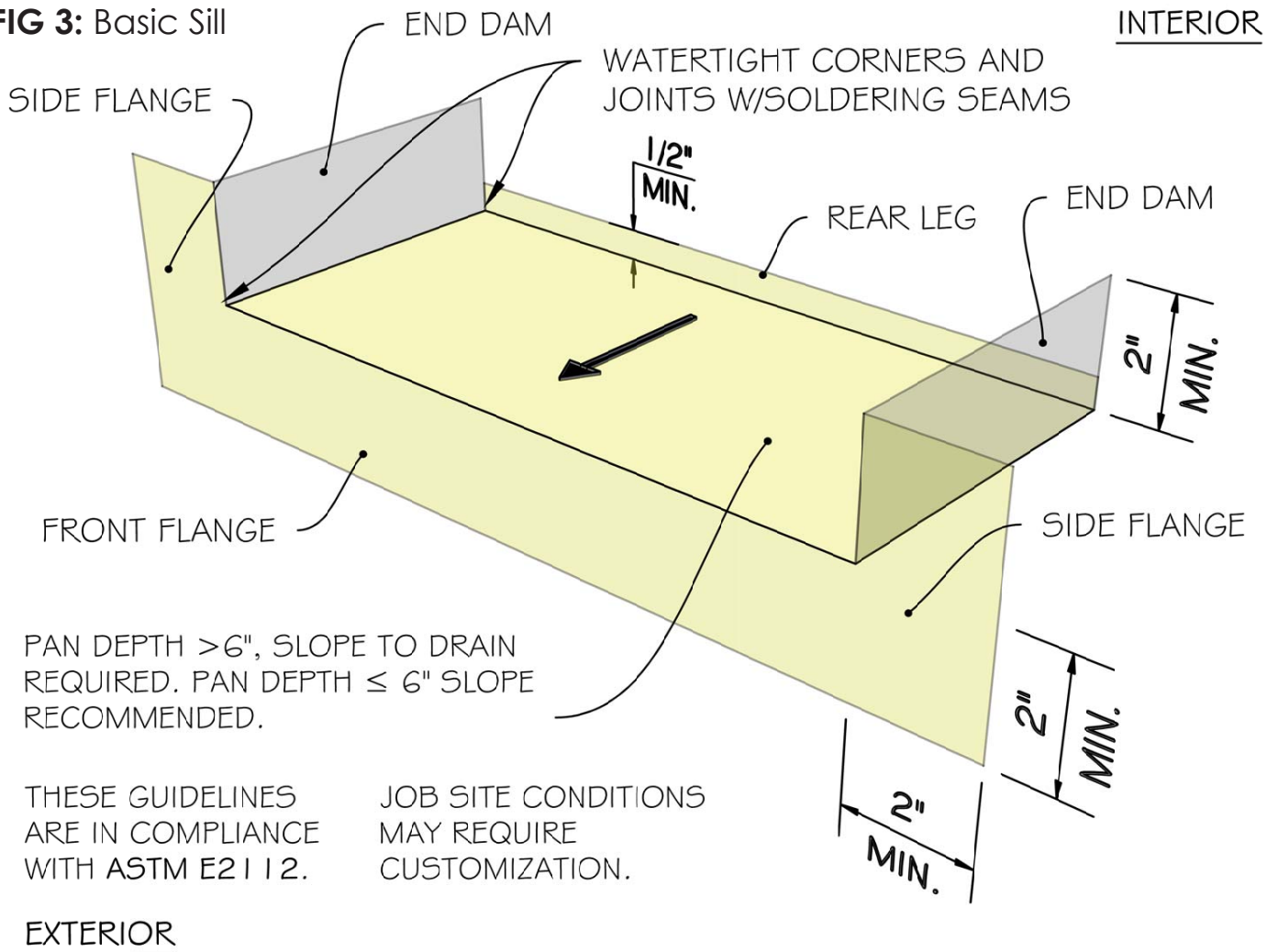

FIG 3: Basic Sill



PAN DEPTH > 6", SLOPE TO DRAIN REQUIRED. PAN DEPTH ≤ 6" SLOPE RECOMMENDED.

THESE GUIDELINES ARE IN COMPLIANCE WITH ASTM E2112.

JOB SITE CONDITIONS MAY REQUIRE CUSTOMIZATION.

EXTERIOR

This unit will not operate or lock properly if the frame is not perfectly plumb, level and square. If a factory service call is requested and the cause of the issue is found to be a unit installed out of square and/or plumb, the service call will be billed to the customer.

Step 3:

Use the predrilled holes on the back edge of the door to place and attach the hinge leaves. The hinges are already on the frame. Test to see if the unit opens and closes smoothly.

Step 4:

Apply handlesets/cylinder thumb-turns if included.

Step 5:

Seal the gap between the door shoe and the bottom rail with a silicone sealant such as OSI Quad Max **FIG 4.**

If there are any questions during installation, please feel free to call our factory at (805) 644-4494 or 1-800-559-9995 (toll free in USA) between the hours of 8:00am and 4:30pm PST.

FIG 4: Sealing Door Shoe Gap with silicone

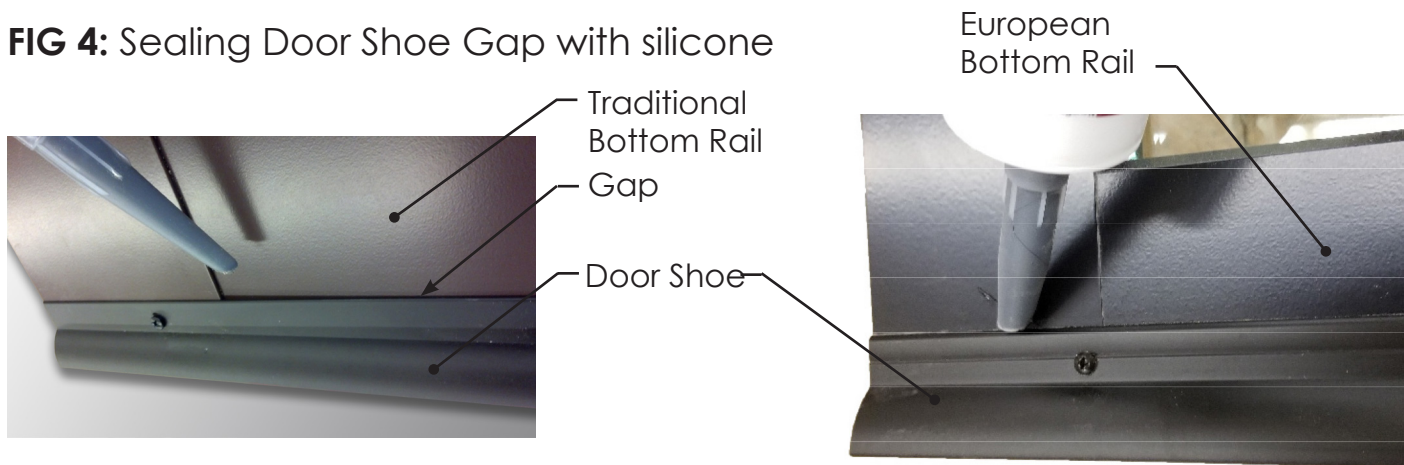
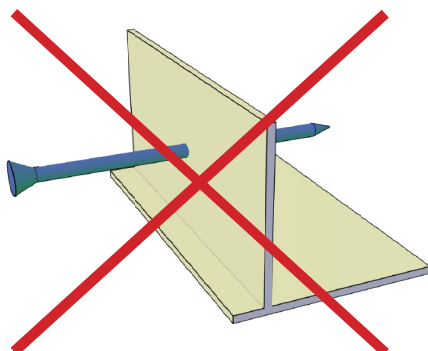

FIG 5: Non-structural Flashing Fin



NON-STRUCTURAL FLASHING FIN.

NOT INTENDED TO BE USED AS AN ANCHORING DEVICE OR NAILING FIN.