

Design Presentation

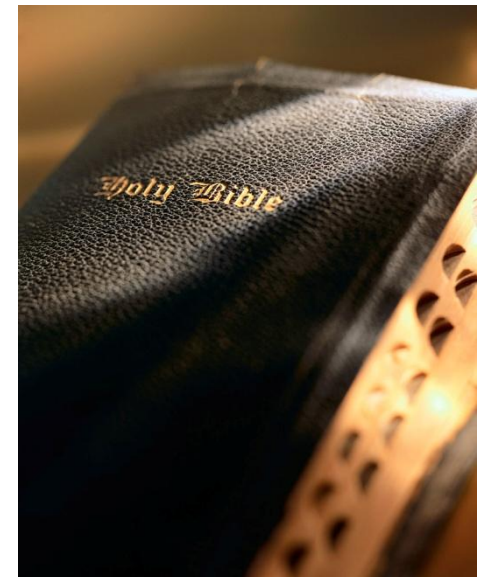

MT. OLIVE MISSIONARY BAPTIST CHURCH

Tuskegee, Alabama

Project No. 2011-006

April 11, 2012

Improving life through comprehensive design



SITE



Site Plan



North

improving life through comprehensive design

SANCTUARY & FELLOWSHIP HALL FLOOR PLAN

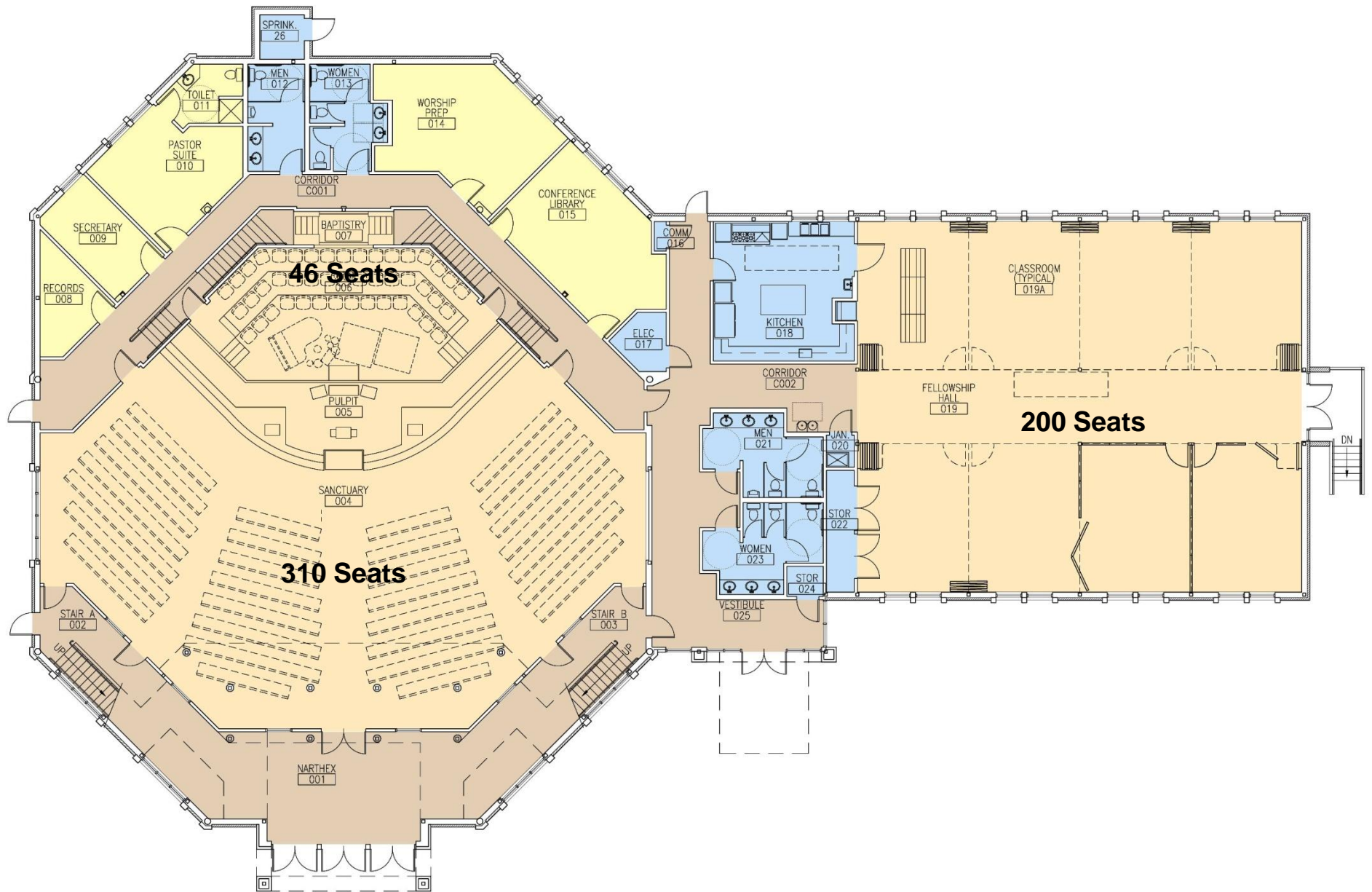

Improving life through comprehensive design

BALCONY FLOOR PLAN

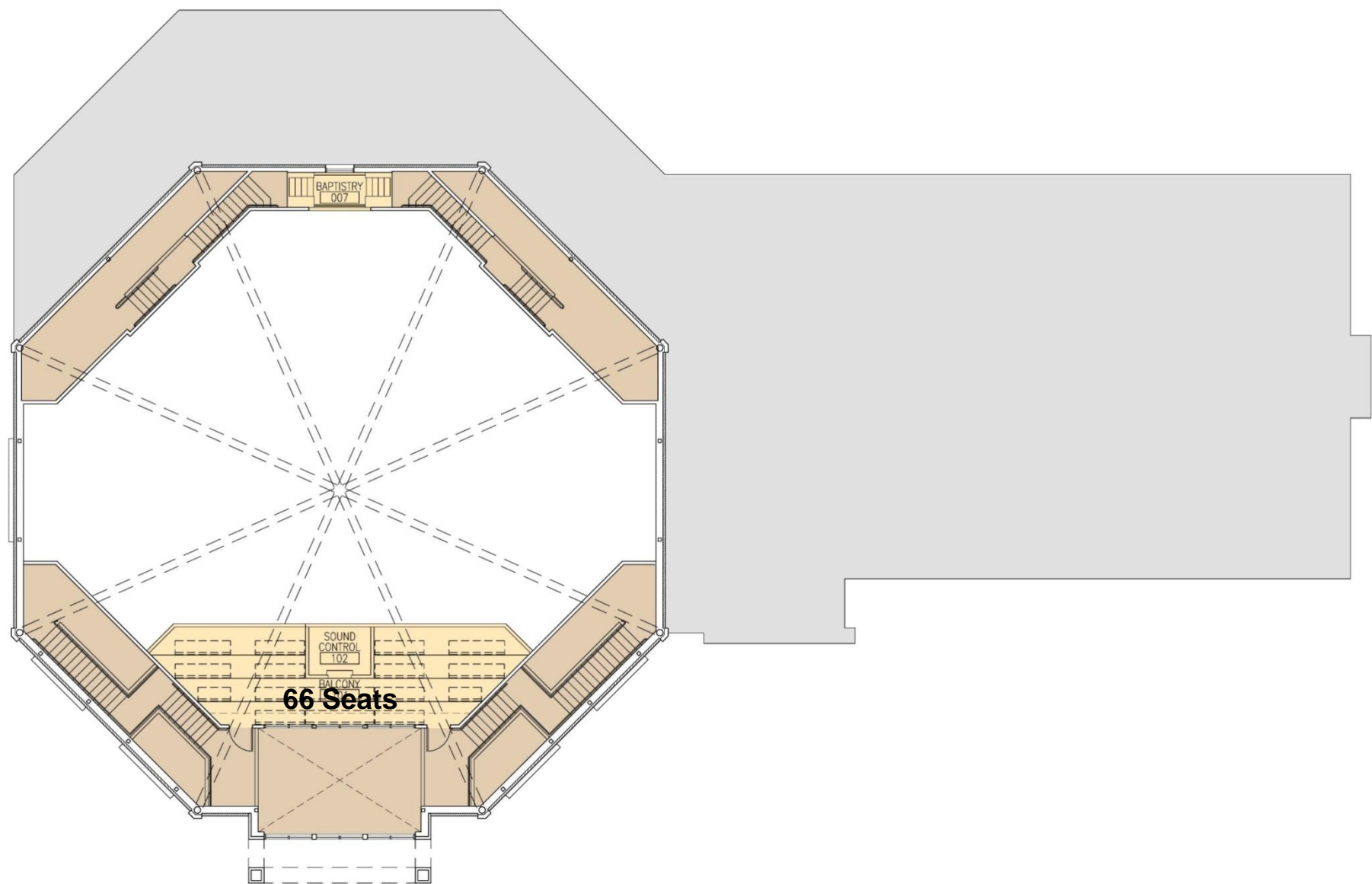

improving life through comprehensive design

EXTERIOR ELEVATIONS



Front (North) Elevation

improving life through comprehensive design

EXTERIOR ELEVATIONS



West Elevation

improving life through comprehensive design

EXTERIOR ELEVATIONS



Rear (South) Elevation

Improving life through comprehensive design

EXTERIOR ELEVATIONS



East Elevation

Improving life through comprehensive design



Front (North) Elevation



West Elevation



East Elevation



Rear (South) Elevation

SHERLOCK, SMITH & ADAMS, INC.

MONTGOMERY / BIRMINGHAM

2101 Magnolia Avenue South / Suite 100 / Birmingham, Alabama 35205 / Phone (205) 254-9100 / Fax (205) 254-9144 / www.ssainc.com